



SHOWERS & SHOWER
ACCESSORIES

SHOWERS & SHOWER ACCESSORIES

Croydex's extensive collection includes everything from overhead showers to adjustable wall brackets and boasts both attractive styling and reliability. So why not choose from this impressive selection of products to refresh and rejuvenate your bathroom.

Water Label & Water Efficient Handsets

The European Water Label is a voluntary scheme and is open to all companies who manufacture or sell products in the UK that meet the criteria. The Bathroom Manufacturer's Association (BMA), the lead trade association for manufacturers of products in the UK is the facilitator of this scheme.

Croydex have been actively selling water efficient shower accessories for many years and have now been recognised by the BMA with several of its water efficient shower handsets now included in the Water Label.

Offering the latest water-saving technology, many of the handsets included in the Water Label feature Croydex's innovative Eco Function. The optional water saving device reduces water usage by up to 50% compared to flow rates through the hand shower without it fitted. Simple to fit, the device is inserted into the handset or showerhead during installation and can be removed as and when required. It can be used in conjunction with most systems, excluding electric showers.

Modern bathroom fittings are designed to be more water efficient without compromising performance.

Water efficient products will help your customers save water and save money on their energy bills because they are not heating so much water.

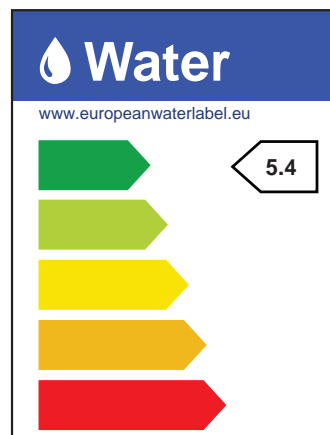

Look for the Water Label above on featured products.

What is the Water Label?

The Water Label enables customers across Europe to easily compare the amount of water different products use and make informed decisions that will save them water and money. Major DIY retailers, builders and plumbers' merchants and manufacturers of bathroom products are committed to using the Water Label for all bathroom fittings.

Thousands of bathroom products are registered with the European Water Label. Once registered, products are given a Water Label rating based on the manufacturers' product information.

You can look online to search for products already registered with the Water Label at www.europeanwaterlabel.eu and click on 'Find a Product'.

How the Label Works

The Water Label shows the amount of water the product uses. Products are grouped into colour-coded performance bands depending on how much water they use. The smaller the arrow, the more water efficient the product with green being the most efficient.

Your customers will be familiar with the style of the labelling as it's similar to the energy labelling used on white goods (like fridges and washing machines) and electronic products.

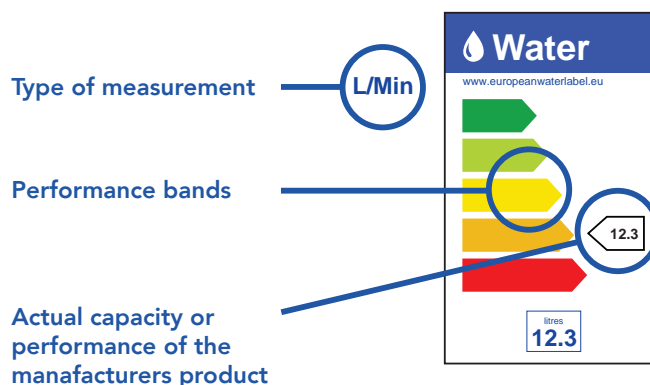

Flexi Fix™ – Shower Screen

FLEXI-FIX SHOWER SCREEN

- 6mm toughened safety glass
- Patented system allows use of existing screw holes
- Simple key system allows single person fitting
- Screen adjustment for out of true walls
- Reversible for left or right hand fit
- Polished aluminium profile



| CODE | DIMENSIONS (HxWxD) |
|-----------------------------------|--------------------|
| AM184032 | 1500 x 830 x 40mm |
| Packaging: Brown box colour label | |



SIMPLE LEVELLING SYSTEM

Unique cam system always aligns your screen on to the bath through existing screw holes for an easier installation

Adjustable cam device locates into the channel and allows existing holes to be used



It also provides vertical and horizontal adjustment

Our locking mechanism holds the screen in place and allows for single person installation and adjustment in final assembly of the glass screen

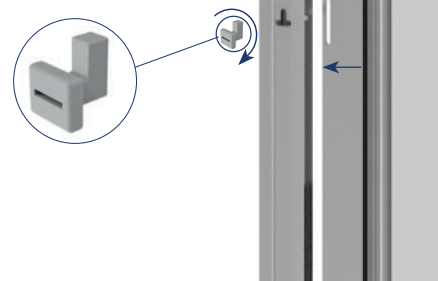

Shower Hoses

1.25M PVC SHOWER HOSE

- Reinforced flexible PVC shower hose with standard bore
- Two conical fitments
- Ideal length for electric showers
- Universal ½" B.S.P. connection



| CODE | FINISH | QUANTITY |
|-----------|--------|----------|
| AM168622 | White | 1 |
| AM168622B | White | 6 |
| AM168641 | Chrome | 1 |
| AM168641B | Chrome | 6 |

Packaging: Full colour box with euro slot

1.5M PVC SHOWER HOSE

- Reinforced flexible PVC shower hose with standard bore
- Two chrome plated conical fitments
- Ideal length for electric showers
- Universal ½" B.S.P. connection



| CODE | FINISH | QUANTITY |
|-----------|--------|----------|
| AM169522 | White | 1 |
| AM169522B | White | 6 |
| AM169541 | Chrome | 1 |
| AM169541B | Chrome | 6 |

Packaging: Full colour box with euro slot

1.5M REINFORCED STAINLESS STEEL SHOWER HOSE

- Reinforced stainless steel shower hose
- Two chrome plated metal conical fitments
- Suitable for use with most electric or mixer showers
- Universal ½" B.S.P. connection



| CODE | FINISH | BORE |
|----------|--------|-------|
| AM550441 | Chrome | Large |

Packaging: Blister pack with euro slot

1.5M FLEXITUBE STAINLESS STEEL SHOWER HOSE

- Stainless steel shower hose with standard bore
- Two chrome plated hex head nuts
- Suitable for use with most electric or mixer showers
- Universal ½" B.S.P. connection



| CODE | FINISH |
|----------|--------|
| AM123540 | Silver |

Packaging: Blister pack with euro slot

1.5M & 1.75M STAINLESS STEEL SHOWER HOSE

- Double wound extra strong stainless steel flexible hose with standard bore
- Two chrome plated conical fitments
- Ideal for bath shower mixers and all showers
- Universal ½" B.S.P. connection



| CODE | DIMENSION | QUANTITY |
|-----------|-----------|----------|
| AM168741 | 1.5m | 1 |
| AM168741B | 1.5m | 6 |
| AM168841 | 1.75m | 1 |
| AM168841B | 1.75m | 6 |

Packaging: Full colour box with euro slot

1.75M REINFORCED STAINLESS STEEL SHOWER HOSE

- Reinforced stainless steel shower hose
- One chrome plated conical fitment and one chrome plated knurled nut
- Suitable for use with most electric or mixer showers
- Universal ½" B.S.P. connection



| CODE | FINISH | BORE |
|----------|--------|-------|
| AM163641 | Chrome | Large |

Packaging: Blister pack with euro slot

Shower Hoses & Handsets

1.75M PREMIUM STRENGTH SHOWER HOSE

NEW

- Reinforced stainless steel shower hose
- One chrome plated conical fitment and one chrome plated knurled nut
- Suitable for use with most electric or mixer showers
- Universal ½" B.S.P. connection



| CODE | FINISH |
|---------------------------------|--------|
| AM156103 | Gold |
| Packaging: Full colour open box | |

2M REINFORCED STAINLESS STEEL SHOWER HOSE

- Reinforced stainless steel shower hose with large bore
- Two metal conical fitments
- Suitable for use with most electric or mixer showers
- Universal ½" B.S.P. connection



| CODE | FINISH |
|--|--------|
| AM550641 | Chrome |
| Packaging: Blister pack with euro slot | |

SHOWERS & SHOWER ACCESSORIES

1.5 – 2M+ STRETCH SHOWER HOSE

- Reinforced stainless steel construction
- 40% Extra length when fully stretched (1.5-2m+)
- Standard bore with one conical fitment and one hexagonal fitment
- Ideal for bath shower mixers and all showers
- Universal ½" B.S.P. connection



| CODE | DIMENSIONS | QUANTITY |
|---|------------|----------|
| AM159741 | 1.5 – 2m+ | 1 |
| AM159741B | 1.5 – 2m+ | 6 |
| Packaging: Full colour box with euro slot | | |

1.5M STRETCH REINFORCED SHOWER HOSE

- Reinforced stretch shower hose
- One conical fitment and one hex head nut
- Gives up to 40% extra length
- Suitable for use with most electric or mixer showers
- Universal ½" B.S.P. connection



| CODE | FINISH | BORE |
|--|--------|-------|
| AM156041 | Chrome | Large |
| Packaging: Blister pack with euro slot | | |

Essential Range – Shower Sets & Handsets

THREE FUNCTION SHOWER HANDSET

- Rub clean nozzles
- Ideal for all shower types
- Universal 1/2" B.S.P. connection



| CODE | FINISH | QUANTITY |
|-----------|--------|----------|
| AM169022 | White | 1 |
| AM169022B | White | 6 |
| AM169041 | Chrome | 1 |
| AM169041B | Chrome | 6 |

Packaging: Full colour box with euro slot

MAXI FIVE FUNCTION SHOWER HANDSET

- Rub clean nozzles
- Ideal for all shower types
- Universal 1/2" B.S.P. connection



| CODE | FINISH | QUANTITY |
|-----------|--------|----------|
| AM169141 | Chrome | 1 |
| AM169141B | Chrome | 6 |

Packaging: Full colour box with euro slot

THREE FUNCTION SHOWER SET

- 1.5m Reinforced PVC hose
- 690mm Riser rail with soap shelf (582mm fixing centres)
- Rub clean nozzles
- Universal 1/2" B.S.P. connection



| CODE | FINISH | QUANTITY |
|-----------|--------|----------|
| AM169322 | White | 1 |
| AM169322B | White | 3 |
| AM169341 | Chrome | 1 |
| AM169341B | Chrome | 3 |

Packaging: Full colour box with euro slot

MAXI FOUR FUNCTION SHOWER SET

- 1.5m Stainless steel hose
- 690mm Riser rail with soap shelf (582mm fixing centres)
- Rub clean nozzles
- Universal 1/2" B.S.P. connection



| CODE | FINISH | QUANTITY |
|-----------|--------|----------|
| AM169441 | Chrome | 1 |
| AM169441B | Chrome | 3 |

Packaging: Full colour box with euro slot

Shower Handsets

ONE FUNCTION SHOWER HANDSET

- One function handset with rub clean nozzles
- Comfort grip ergonomically designed handle
- Universal 1/2" B.S.P. connection



| CODE | FINISH |
|----------|--------|
| AM153222 | White |
| AM153241 | Chrome |

Packaging: Blister pack with euro slot

NERO ONE FUNCTION SHOWER HANDSET



- One function handset with rub clean nozzles
- Comfort grip ergonomically designed handle
- Universal 1/2" B.S.P. connection



| CODE | FINISH |
|----------|--------|
| AM173922 | White |
| AM173941 | Chrome |

Packaging: Open colour box

SHOWERS & SHOWER ACCESSORIES

THREE FUNCTION SHOWER HANDSET

- Three function handset with rub clean nozzles
- Suitable for low pressure systems
- Universal 1/2" B.S.P. connection



| CODE | FINISH |
|----------|--------|
| AM150222 | White |
| AM150241 | Chrome |

Packaging: Blister pack with euro slot

NERO THREE FUNCTION SHOWER HANDSET



- Three function handset with rub clean nozzles
- Suitable for low pressure systems
- Universal 1/2" B.S.P. connection



| CODE | FINISH |
|----------|--------|
| AM174041 | Chrome |

Packaging: Open colour box

FIVE FUNCTION SHOWER HANDSET

- Five function handset with rub clean nozzles
- Suitable for low pressure systems
- Universal 1/2" B.S.P. connection



| CODE | FINISH |
|----------|--------|
| AM150322 | White |
| AM150341 | Chrome |

Packaging: Blister pack with euro slot

NERO FIVE FUNCTION SHOWER HANDSET



- Five function handset with rub clean nozzles
- Suitable for low pressure systems
- Universal 1/2" B.S.P. connection



| CODE | FINISH |
|----------|--------|
| AM190341 | Chrome |

Packaging: Open colour box

Eco Function

CONTOUR MINI TWO FUNCTION SHOWER HANDSET

- 85mm Diameter two function handset with rub clean nozzles
- Universal 1/2" B.S.P. connection



| CODE | FINISH |
|--|--------|
| AM163041 | Chrome |
| Packaging: Blister pack with euro slot | |

CONTOUR MIDI THREE FUNCTION SHOWER HANDSET

- 105mm Diameter three function handset with rub clean nozzles
- Universal 1/2" B.S.P. connection



| CODE | FINISH |
|--|--------|
| AM163341 | Chrome |
| Packaging: Blister pack with euro slot | |

CONTOUR MAXI FOUR FUNCTION SHOWER HANDSET

- Large 125mm diameter four function handset with rub clean nozzles
- Universal 1/2" B.S.P. connection



| CODE | FINISH |
|--|--------|
| AM157641 | Chrome |
| Packaging: Blister pack with euro slot | |

MATRIX THREE FUNCTION SHOWER HANDSET

- 105mm Diameter three function handset with rub clean nozzles
- Chrome plated faceplate
- Universal 1/2" B.S.P. connection



| CODE | FINISH |
|--|--------|
| AM170641 | Chrome |
| Packaging: Blister pack with euro slot | |

MATRIX FIVE FUNCTION SHOWER HANDSET

- Large 120mm diameter five function handset with rub clean nozzles
- Chrome plated faceplate
- Universal 1/2" B.S.P. connection



| CODE | FINISH |
|--|--------|
| AM170741 | Chrome |
| Packaging: Blister pack with euro slot | |

Eco Function



SELF CLEANING FIVE FUNCTION SHOWER HANDSET

- Chrome five function shower handset
- Self cleaning; internal pins eject limescale deposits
- Removable venturi cartridge
- Universal 1/2" B.S.P. connection



| CODE | FINISH |
|----------|--------|
| AM178041 | Chrome |

Packaging: Full colour open box

SHOWERS & SHOWER ACCESSORIES

SILK SPRAY THREE FUNCTION SHOWER HANDSET

- Silk spray function; soft & gentle spray sensation
- Chrome three function shower handset
- Rub clean nozzles
- Universal 1/2" B.S.P. connection



| CODE | FINISH |
|----------|--------|
| AM177041 | Chrome |

Packaging: Full colour open box

SILK SPRAY FIVE FUNCTION SHOWER HANDSET

- Silk spray function; soft & gentle spray sensation
- Chrome five function shower handset
- Rub clean nozzles
- Universal 1/2" B.S.P. connection



| CODE | FINISH |
|----------|--------|
| AM177141 | Chrome |

Packaging: Full colour open box

INCLUSIVE FOUR FUNCTION SHOWER HANDSET - ECO

- 85mm Diameter head with rub clean nozzles
- Tactile rubber handle for easier gripping
- Large lever makes switching functions easier
- Universal 1/2" B.S.P. connection



| CODE | FINISH |
|----------|----------------|
| AM151341 | Chrome & White |

Packaging: Blister pack with euro slot



Shower Sets

SINGLE FUNCTION BATH & SHOWER SET WITH BRACKET

- Complete shower set
- Single function handset with rub clean nozzles
- 1750mm Stainless steel hose with large bore
- One conical fitment and one knurled nut
- Multi-position wall bracket
- Universal 1/2" B.S.P. connection



water label **21.4** L/Min

| CODE | FINISH |
|--|--------|
| AM162041 | Chrome |
| Packaging: Blister pack with euro slot | |

UNO ONE FUNCTION SHOWER SET

- Complete shower set
- 1000mm Vari-Fit riser rail allows existing screw holes to be re-used providing they are no more than 960mm apart (see page 51)
- Improved mobility and flexibility with 1000mm riser rail
- Single function handset with rub clean nozzles
- Multi-position shower handset adjustment
- 1500mm Stainless steel shower hose with large bore
- Universal 1/2" B.S.P. connection



| CODE | FINISH |
|----------------------------|--------|
| AM162141 | Chrome |
| Packaging: Full colour box | |

THREE FUNCTION SHOWER SET

- Complete shower set
- 710mm Riser rail
- Three function handset with rub clean nozzles
- Multi-position shower handset adjustment
- 1500mm Heavy duty shower hose with standard bore
- Universal 1/2" B.S.P. connection



water label **23.1** L/Min

| CODE | FINISH |
|--|--------|
| AM150922 | White |
| AM150941 | Chrome |
| Packaging: Blister pack with euro slot | |

TRIO THREE FUNCTION SHOWER SET

- Complete shower set
- 655mm Vari-Fit riser rail allows existing screw holes to be re-used providing they are no more than 550mm apart (see page 51)
- Three function handset with rub clean nozzles
- Extra strong 1500mm stainless steel hose with medium bore
- Hose retaining ring for additional security
- Multi-position shower handset adjustment
- Chrome plated soap dish
- Universal 1/2" B.S.P. connection



water label **5.7** L/Min

50% WATER SAVING

Optional Eco Feature

Vari-Fit

Flexible Mounting System

| CODE | FINISH |
|--|--------|
| AM158441 | Chrome |
| Packaging: Blister pack with euro slot | |

Shower Sets

MATRIX THREE FUNCTION SHOWER SET

- Complete shower set
- 655mm Vari-Fit riser rail allows existing screw holes to be re-used providing they are no more than 550mm apart (see page 51)
- 105mm Diameter shower handset with rub clean nozzles
- Multi-position shower handset adjustment
- Extra strong 1500mm stainless steel hose with medium bore
- Hose retaining ring for additional security
- Universal 1/2" B.S.P. connection



3 Spray Patterns



| CODE | FINISH |
|----------|--------|
| AM173641 | Chrome |

Packaging: Blister pack with euro slot

MATRIX FIVE FUNCTION SHOWER SET

- Complete shower set
- 655mm Vari-Fit riser rail allows existing screw holes to be re-used providing they are no more than 550mm apart (see page 51)
- 120mm Diameter shower handset with rub clean nozzles
- Multi-position shower handset adjustment
- Extra strong 1500mm stainless steel hose with medium bore
- Hose retaining ring for additional security
- Universal 1/2" B.S.P. connection



5 Spray Patterns



| CODE | FINISH |
|----------|--------|
| AM173741 | Chrome |

Packaging: Blister pack with euro slot

SHOWERS & SHOWER ACCESSORIES

INCLUSIVE SHOWERING KIT

- Complete shower set
- 600mm Stainless steel grab bar with concealed fixings
- Four function 85mm diameter head with rub clean nozzles
- Tactile rubber handle for easier gripping
- Large lever makes switching functions easier
- 2000mm Chrome hose with large bore
- Assistive slider with large button, easy to use
- Universal 1/2" B.S.P. connection
- Fixings not included



4 Spray Patterns



| CODE | FINISH |
|----------|--------|
| AP600241 | Chrome |

Packaging: Brown box with colour label

CONTOUR DUO COMBI SET

- Converts existing handshowers into overhead or handshower
- Integrated riser rail, shower arm and diverter
- A Vari-Fit riser rail allows existing screw holes to be re-used providing they are no more than 800mm apart
- Multi-position shower handset adjustment
- Small round fixed pivot overhead shower
- Contour Mini two function handset with rub clean nozzles
- 1500mm Reinforced stainless steel hose with medium bore
- Not suitable for electric showers
- Suitable for pressures 1 bar and above
- Universal 1/2" B.S.P. connection



2 Spray Patterns



| CODE | FINISH |
|----------|--------|
| AM162441 | Chrome |

Packaging: Full colour box

Flexi Fix™ – Shower Sets

Flexi Fix™

SCREW OR GLUE

SHOWERS & SHOWER
ACCESSORIES

THREE WAYS TO FIX – YOU CHOOSE HOW

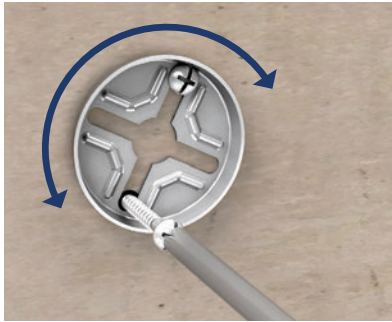

RE-FIX

Aligns to old holes



SCREW-FIX

To new holes

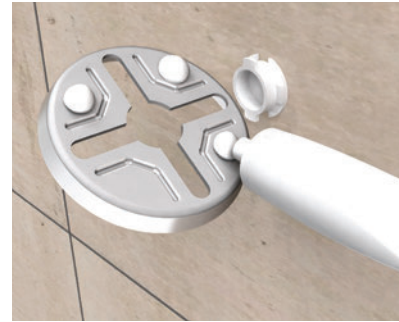

GLUE-FIX

To most surfaces

STEP 1. AJUSTABLE WALL BRACKETS STEP 2. EASY FIX UNIQUE 'X' PLATE

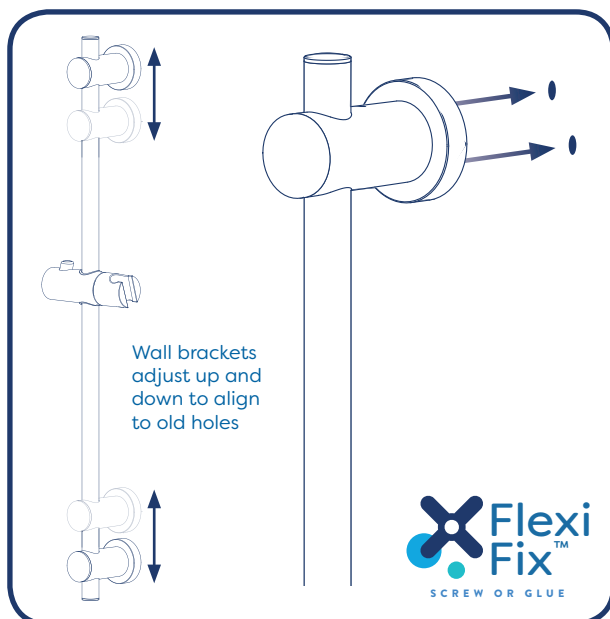

Flexi Fix™ - Shower Sets

FLEXI-FIX RISER RAIL

- Flexi-Fix brackets can be fixed using existing screw holes (up to 600mm apart) or glued, avoiding drilling completely
- 600mm Riser rail
- Multi-position shower handset adjustment



| CODE | FINISH |
|---------------------------------|--------|
| AM182641 | Chrome |
| Packaging: Full colour open box | |



FLEXI-FIX THREE FUNCTION SHOWER SET

- Complete shower set
- Flexi-Fix brackets can be fixed using existing screw holes or glued, avoiding drilling completely
- 600mm Riser rail provides flexible height adjustment to suit a variety of users
- Multi-position shower handset adjustment
- Large three function chrome handset with rub clean nozzles
- Reinforced 1500mm stainless steel hose with medium bore
- Universal ½" B.S.P. connection
- Rub clean nozzles



| CODE | FINISH |
|---------------------------------|--------|
| AM182441 | Chrome |
| Packaging: Full colour open box | |



3 Spray Patterns

FLEXI-FIX FIVE FUNCTION SHOWER SET

- Complete shower set
- Flexi-Fix brackets can be fixed using existing screw holes or glued, avoiding drilling completely
- 600mm Riser rail provides flexible height adjustment to suit a variety of users
- Multi-position shower handset adjustment
- Large five function chrome handset with rub clean nozzles
- Reinforced 1500mm stainless steel hose with medium bore
- Universal ½" B.S.P. connection
- Rub clean nozzles



5 Spray Patterns



| CODE | FINISH |
|---------------------------------|--------|
| AM182541 | Chrome |
| Packaging: Full colour open box | |



Overhead Showers

SMALL ROUND SHOWER OVERHEAD

- 120mm Diameter round shower handset with rub clean nozzles
- For use with a shower arm or a shower panel
- Universal 1/2" B.S.P. connection



water label **10** L/Min



| CODE | FINISH |
|--|--------|
| AM153541 | Chrome |
| Packaging: Blister pack with euro slot | |

TRADITIONAL RAIN SHOWER OVERHEAD

- 173mm Diameter single function chrome plated pivot head with rub clean nozzles
- For use with a shower arm or a shower panel
- Universal 1/2" B.S.P. connection



water label **27.3** L/Min



| CODE | FINISH |
|--|--------|
| AM169841 | Chrome |
| Packaging: Blister pack with euro slot | |

TRADITIONAL RAIN HEAD SET (HEAD, ARM & HOSE)

- 173mm Diameter chrome plated pivot head with rub clean nozzles
- 360mm Chrome plated fixed shower arm with hose connector
- 1500mm Stainless steel hose
- Universal 1/2" B.S.P. connection



water label **27.3** L/Min



| CODE | FINISH |
|----------------------------|--------|
| AM159641 | Chrome |
| Packaging: Full colour box | |



GENERIC SHOWER ARM

- Chrome plated brass shower arm
- Universal 1/2" B.S.P. connection



| CODE | FINISH | LENGTH |
|--|--------|--------|
| AM162841 | Chrome | 200mm |
| Packaging: Blister pack with euro slot | | |

See our demonstration videos online at www.croydex.com or scan the QR code below

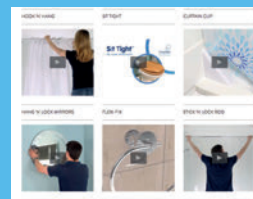



SENSATIONAL WATER SAVING

Uninspiring and expensive showers are a thing of the past with the new Aqua Air showering products from Croydex.

Aqua Air products produce a bigger and softer water droplet to enhance and improve your showering sensation and pleasure, whilst also reducing your water consumption without the need for a water saving device.

How Aqua Air works is simple – water flowing through the shower head draws in air, which is then mixed with the water. This creates bigger, softer, aerated water droplets within a volumised shower spray, which enhance the showering sensation and provide a high quality showering experience with lower water consumption.

In fact Aqua Air shower handsets can save up to 50% water when compared to similar standard shower handsets.

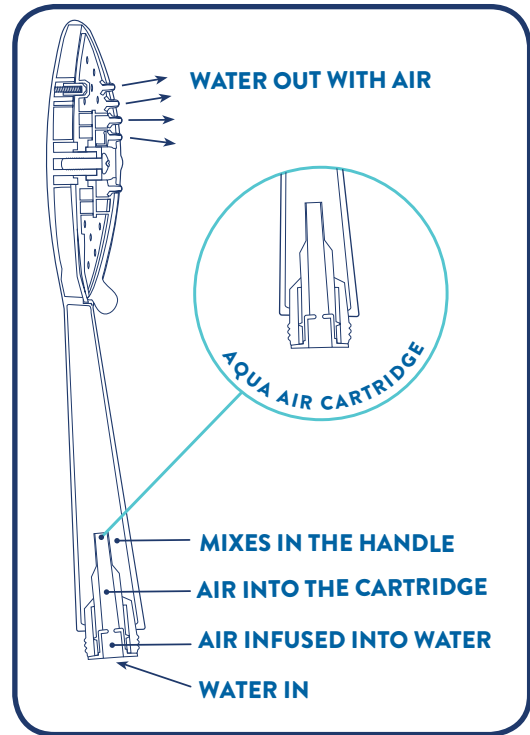

SHOWERS & SHOWER ACCESSORIES

The BMA Water Label is a voluntary scheme and is open to all companies who manufacture or sell product in the UK and Europe that meets the criteria for water efficiency products as defined by technical experts within the bathroom industry. All Aqua Air shower heads are listed with the European Water Label Scheme. Your guarantee of water efficient transparency.

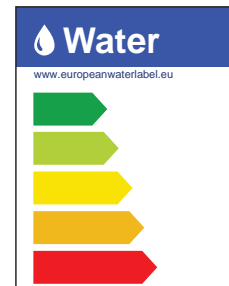

EASY INSTALLATION



Unscrew your existing shower head from the shower hose and discard old washer. Clean threads on shower hose.



Fully insert the Aqua Air cartridge and position the washer supplied in the connector of your shower hose and attach it to the shower head, do not over-tighten.

If pressures are low the aqua air cartridge can be removed to provide an excellent aerated spray.



To retain best quality finish, clean product regularly with a soft damp cloth. Do not use abrasive or chemical cleaners, as these may damage the product.

Aqua Air™ - Shower Handsets & Sets

KEILA ONE FUNCTION SHOWER HANDSET

NEW

- Chrome one function shower handset
- Universal ½" B.S.P. connection
- Rub clean nozzles
- Supplied with Aqua Air water saving device



1 Spray Pattern
Aqua Air™



| CODE | FINISH |
|---------------------------------|--------|
| AM178241 | Chrome |
| Packaging: Full colour open box | |

EDASSA THREE FUNCTION SHOWER HANDSET

NEW

- Chrome three function shower handset
- Universal ½" B.S.P. connection
- Rub clean nozzles
- Supplied with Aqua Air water saving device



3 Spray Patterns
Aqua Air™

| CODE | FINISH |
|---------------------------------|--------|
| AM178341 | Chrome |
| Packaging: Full colour open box | |

TALIA THREE FUNCTION SHOWER HANDSET

NEW

- Chrome three function shower handset
- Universal ½" B.S.P. connection
- Rub clean nozzles
- Supplied with Aqua Air water saving device



3 Spray Patterns
Aqua Air™

| CODE | FINISH |
|---------------------------------|--------|
| AM178441* | Chrome |
| Packaging: Full colour open box | |

BELMORE FIVE FUNCTION SHOWER HANDSET

NEW

- Chrome five function shower handset
- Universal ½" B.S.P. connection
- Rub clean nozzles
- Supplied with Aqua Air water saving device



5 Spray Patterns
Aqua Air™

| CODE | FINISH |
|---------------------------------|--------|
| AM178541 | Chrome |
| Packaging: Full colour open box | |

VARONE FIVE FUNCTION SHOWER HANDSET

NEW

- Chrome five function shower handset
- Universal ½" B.S.P. connection
- Rub clean nozzles
- Supplied with Aqua Air water saving device



5 Spray Patterns
Aqua Air™

| CODE | FINISH |
|---------------------------------|--------|
| AM178641 | Chrome |
| Packaging: Full colour open box | |

SHOWERS & SHOWER ACCESSORIES

Riser Rails

RISER RAIL

- 710mm Riser rail
- Multi-position shower handset adjustment
- Fits all shower hoses with a standard conical fitting
- Clear soap dish



| CODE | FINISH |
|----------|--------|
| AM150422 | White |
| AM150441 | Chrome |

Packaging: Blister pack with euro slot

VARIO RISER RAIL

- 620mm Riser rail
- Allows existing screw holes to be re-used providing they are no more than 610mm apart (see below)
- Multi-position shower handset adjustment
- One adjustable wall bracket
- Fits all shower hoses with a standard conical fitting



| CODE | FINISH |
|----------|--------|
| AM163741 | Chrome |

Packaging: Blister pack with euro slot

VARI-FIT RISER RAIL

- 655mm Riser rail
- Allows existing screw holes to be re-used providing they are no more than 550mm apart (see right)
- Multi-position shower handset adjustment
- One adjustable wall bracket
- Hose ring and soap dish
- Fits all shower hoses with a standard conical fitting



| CODE | FINISH |
|----------|--------|
| AM158241 | Chrome |

Packaging: Blister pack with euro slot

Vari-Fit

The products marked with the Vari-Fit logo are supplied with a flexible mounting system which allows existing screw holes to be re-used, so additional screw holes do not have to be drilled.

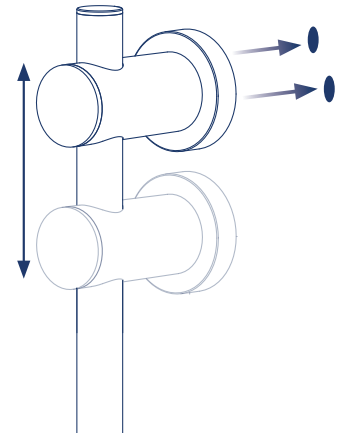

UNIVERSAL RISER RAIL SLIDER

- Adjustable to fit riser rails from 18 - 25mm diameter
- Durable plastic
- Easy retro fit
- Perfect to replace broken sliders



| CODE | FINISH |
|----------|--------|
| AM710122 | White |
| AM710141 | Chrome |

Packaging: Polybag with header card

ADJUSTABLE WALL BRACKET

- Multi-position wall bracket
- Fits shower hoses with a standard conical fitting
- Suitable for all Croydex shower hoses



| CODE | FINISH |
|----------|--------|
| AM150622 | White |
| AM150641 | Chrome |

Packaging: Blister pack with euro slot

SHOWERS & SHOWER ACCESSORIES

Sprays

SHAMPOO SPRAY

- Suitable for 1/2" round or oval basin taps only
- An economic handset with a small square rose
- 750mm Hose length



| CODE | FINISH |
|---------------------------------------|--------|
| AA101022 | White |
| Packaging: Plastic bag with euro slot | |

BATH & SHAMPOO SPRAY

- Universal tap connectors
- Comfortable ergonomic handset shape
- Single function handset with rub clean nozzles
- Compatible with most square, round or oval bath or basin taps
- 1000mm Hose length



| CODE | FINISH |
|--|--------|
| AA108022 | White |
| Packaging: Blister pack with euro slot | |

FREEWAY PLUS

- Universal tap connectors
- Controllable shampoo spray: press for saturating spray and release for gentle flow
- Compatible with most square, round or oval bath or basin taps
- 1000mm Hose length



| CODE | FINISH |
|--|--------|
| AA202022 | White |
| Packaging: Blister pack with euro slot | |

BATH SHOWER MIXER SET

- Best suited to round taps
- Easy to install semi-permanent shower unit
 - Fix the diverter to the taps and move the lever to divert the water between the bath and shower
- Complete with riser rail, 1500mm flexitube hose and single function handset with rub clean nozzles

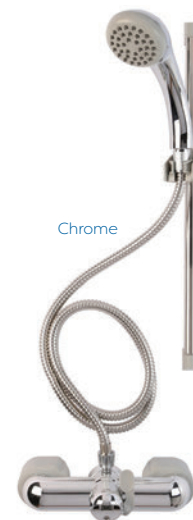

| CODE | FINISH | DIMENSIONS |
|----------|--------|------------|
| AB210022 | White | 430mm |
| AB210040 | Silver | 430mm |
| AB220041 | Chrome | 430mm |

Packaging: Blister pack with euro slot

Secura Sprays

SECURA SPRAY

- Universal tap connectors
- Includes retaining straps; suitable for use with high and low pressure systems up to 3 bar (does not come off tap at high pressure)
- Single function handset with rub clean nozzles
- Handset wall bracket included
- 1750mm Hose length



1 Spray Pattern

| CODE | FINISH |
|---|--------|
| AA107022 | White |
| Packaging: Full colour box with euro slot | |

FREEWAY SECURA

- Universal tap connectors
- Includes retaining straps; suitable for use with high and low pressure systems up to 3 bar (does not come off tap at high pressure)
- Controllable spray; press for saturating flow and release for gentle flow
- 1000mm Hose length



2 Spray Patterns

| CODE | FINISH |
|---|--------|
| AA107422 | White |
| Packaging: Full colour box with euro slot | |

SECURA BATH SHOWER SET

- Universal tap connectors
- Includes retaining straps; suitable for use with high and low pressure systems up to 3 bar (does not come off tap at high pressure)
- Single function handset with rub clean nozzles
- Riser rail included
- 1750mm Hose length
- No plumbing required



1 Spray Pattern

| CODE | FINISH |
|---|--------|
| AB160022 | White |
| Packaging: Full colour box with euro slot | |



SHOWERS & SHOWER ACCESSORIES

Bath & Shower Seal Kits & Accessories

CONNECT-EZE

- Surface mounted connector for bar mixers
- Provides stability and support without reinforcing battens inside the wall
- Simple, easy, quick assembly
- Compression fittings suitable for copper and plastic pipe
- Suitable for all wall mounted showers and bath shower mixers with 3/4" B.S.P. female connecting nuts
- Pack includes 2 connectors

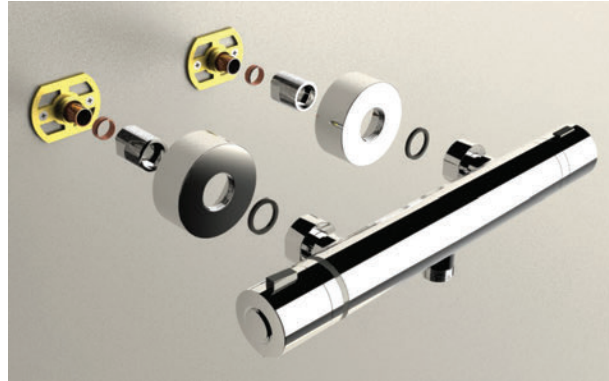

| CODE | FINISH |
|--|----------------|
| AM170341 | Chrome & White |
| Packaging: Blister pack with euro slot | |

MAGNETIC SHOWER CURTAIN CLIP

- For use with in-bath showers and curtains
- Minimises water leakage by creating a barrier between the bath and the wall
- Integrated magnetic retainer holds shower curtain in place
- Easy to install (silicon sealant not included)

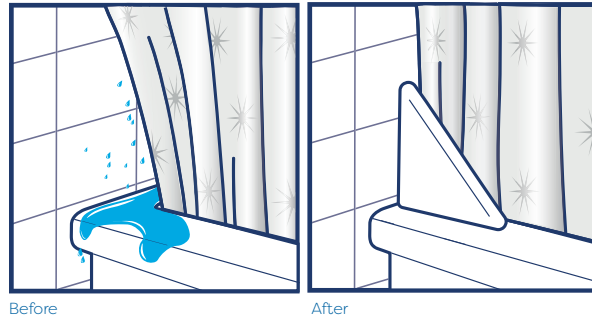

| CODE | FINISH |
|-------------------------------------|--------|
| AM160622 | White |
| Packaging: Polybag with header card | |

BATH & SHOWER SCREEN SEAL KITS

- A replacement translucent seal kit for bath screens
- Sticks to glass or aluminium frames
- Suitable for standard & folding bath/shower screens
- Quick and easy to install
- All fixings supplied

Bath Screen Seal:1-8mm Bath Screen Seal: 8-11mm Shower Screen Seal



| CODE | SEAL KIT | LENGTH | FITS GAP |
|--|---------------|--------|----------|
| AM160332 | Bath Screen | 1000mm | 1-8mm |
| AM160432 | Bath Screen | 1000mm | 8-11mm |
| AM160532 | Shower Screen | 1000mm | |
| Packaging: Blister pack with euro slot | | | |

RIGID SEAL KITS

- A replacement translucent rigid seal kit for bath screens
- Suitable for panels 4 - 6mm thick
- Quick and easy to install

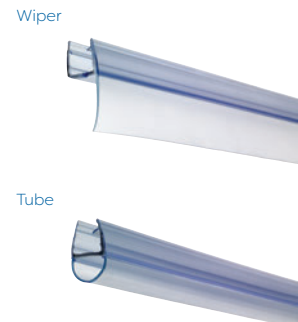

| CODE | LENGTH | SEAL TYPE |
|--|--------|-----------|
| AM161332 | 1000mm | Wiper |
| AM161432 | 1000mm | Tube |
| Packaging: Protective card tube with label | | |

Water Saving and Tap Accessories



Water is something most of us take for granted; the average person in England and Wales uses approximately 150 litres of water per day, mainly for bathing, cooking, cleaning, drinking and flushing the WC. This is an increase of 50% more water than 25 years ago and in real terms we actually use in excess of 3,400 litres of water every day, as all that we consume has embedded water. As more than 60% of water used in the home is in the bathroom it is a good starting point to ask how much water a product uses when buying bathroom products.

In February 2009 the government announced plans to retrofit every home in the country for energy efficiency, and to make all homes and buildings zero carbon by 2050, revolutionising the energy efficiency of British properties.

Today's modern households have the luxury of high pressure water systems. As more and more households are metered this means that the homeowner is paying for the wasted water and increasingly expensive energy consumption through lack of knowledge or education.

Croydex offers a range of water saving flow regulators that can be added to existing taps or showers* to allow you to save water where high pressures exist without compromising the performance of your tap or shower.

Flow regulators are produced with an ingenious design of components that compensates for increasing pressures whilst keeping the flow constant. This ensures that a constant flow of water is maintained regardless of the water pressure as soon as the regulator reaches the pressure where it starts to regulate. At a pressure of 1 bar the O-ring in the core of the flow regulator begins to compress around the core of the regulator insert so that the water passageway begins to be restricted, this continues as pressure increases. That way you save water, but still keep a good water pressure with a constant flow rate.

The universal adaptor rings for both male and female connections mean that these products can be used on any tap or showers that have a suitable threaded outlet and, as a large amount of water used in the bathroom and kitchen is hot water, the cost saving is not only in the water bill but also on energy bills as well.

Croydex has always been a supporter of energy saving and has products listed on the ever increasing and popular Water Label Scheme administered by the Bathroom Manufacturer's Association. So whether through the purchase of a new product or the conversion of an old product, you can rest assured you are saving on energy.

* Please note these regulators are not suitable for electric showers or electric hand washing water heaters. These products are designed with a specific flow rate to suit the individual units and any change to this may result in an unsatisfactory performance.
 ** Type 1 taps from EN 200:2008 deliver 12 litres per minute
 *** Type 1 Bath shower mixers from EN 200:2008 deliver 12 litres per minute. Showers and bath mixers from EN 1111:1998 deliver 12 litres per minute

SHOWERS & SHOWER ACCESSORIES

SHOWER ADAPTOR

- The adaptor fits between:
 - Shower arm to showerhead
 - Mixer to hose
 - Hose to handshower
- 8 Litres per minute provides a typical saving of 4 litres per minute***
- For pressures above 1 bar



SHOWER FLOW LIMITER PACK

- Pack includes 3 flow regulators
- For use with Shower Adaptor AM164541
- Flow regulator provides a typical saving of:
 - Green 6 litres per minute***
 - Blue 4 litres per minute***
 - Orange 2 litres per minute***
- For pressures above 1 bar



| CODE | FINISH |
|--|--------|
| AM164541 | Chrome |
| Packaging: Blister pack with euro slot | |

| CODE |
|--|
| AM164641 |
| Packaging: Blister pack with euro slot |

Water Saving Shower and Tap Accessories

UNIVERSAL MIXER TAP ADAPTOR WITH 4 LITRE FLOW REGULATOR

- Adaptor includes universal ring which enables fitment to external threads
- Produces aerating – champagne effect
- 4 Litres per minute provides a typical saving of 8 litres per minute**
- For pressures above 1 bar



| CODE | FINISH |
|--|--------|
| TB103841 | Chrome |
| Packaging: Blister pack with euro slot | |

UNIVERSAL SWIVEL MIXER TAP ADAPTOR WITH 8L FLOW REGULATOR

- Adaptor includes universal ring which enables fitment to external threads
- Swivel joint provides easy rinsing
- Produces aerating – champagne effect
- 8 Litres per minute provides a typical saving of 4 litres per minute**
- For pressures above 1 bar



| CODE | FINISH |
|--|--------|
| TB103941 | Chrome |
| Packaging: Blister pack with euro slot | |

2 LITRE SPRAY NOZZLE FLOW REGULATOR AND SPANNER PACK

- 2 Litres per minute grey flow regulator insert x2
- Provides a typical saving of 10 litres of water per minute**
- Spray for effective handrinse/handwashing
- Includes universal spanner fitment tool
- For pressures above 1 bar



| CODE |
|--|
| TB104041 |
| Packaging: Blister pack with euro slot |

4 LITRE FLOW REGULATOR AND SPANNER PACK

- 4 Litres per minute yellow flow regulator insert x2
- Provides a typical saving of 8 litres of water per minute**
- Produces aerating – champagne effect
- Includes universal spanner fitment tool
- For pressures above 1 bar



| CODE |
|--|
| TB104141 |
| Packaging: Blister pack with euro slot |

6 LITRE FLOW REGULATOR AND SPANNER PACK

- 6 Litres per minute green flow regulator insert x2
- Provides a typical saving of 6 litres of water per minute**
- Produces aerating – champagne effect
- Includes universal spanner fitment tool
- For pressures above 1 bar



| CODE |
|--|
| TB104241 |
| Packaging: Blister pack with euro slot |

8 LITRE FLOW REGULATOR AND SPANNER PACK

- 8 Litres per minute blue flow regulator insert x2
- Provides a typical saving of 4 litres of water per minute**
- Produces aerating – champagne effect
- Includes universal spanner fitment tool
- For pressures above 1 bar



| CODE |
|--|
| TB104341 |
| Packaging: Blister pack with euro slot |

